

FLEXIBLE SPACE @ GREEN PARK

WORKSPACES FROM
809 - 2,500 SQ FT

100
LONGWATER
AVENUE

GreenPark 
a mapleiree property



FLEXIBLE SPACE TO SUIT EVERY BUSINESS

100 Longwater Avenue offers a range of flexible suites from 809 - 2,560 sq ft in the East Wing.

The striking waterside building houses our Business Centre with world-class conference facilities. It has a manned reception and on-site security, Byte café, and showers for the cyclists on your team.

OFFICES FROM AS FEW

AS FIVE DESKS



FLEXIBLE LEASE TERMS

Between 1 – 3 years. The perfect solution for a short-term project.

ALL-INCLUSIVE LEASES

Inclusive of business rates, service charge, insurance and electricity. Significant CapEx saving.

STYLISH & PRIVATE

Fully refurbished workspace ready to occupy.

FURNISHED OR UNFURNISHED

High-quality Landlord delivered fitted and furnished offices. Tenants are able to carry out their own fit out or Green Park can offer custom fitted suites.

SAFE & SECURE

24 hour security on the Park.

ALL THE ESSENTIALS

Air-conditioning, heating, data and telephony, 13-amp power and lighting.

RECEPTION SERVICES

Defined switchboard service (call costs not included), mail receipt and sort & basic office cleaning.

SPACE TO GROW

Ability to expand or take flexible space within an award winning business park.



| AVAILABILITY | SUITE | PEOPLE | SQ FT | SQ M | FITTED & FURNISHED |
|--------------|----------|--------|--------|-------|--------------------|
| Third floor | Suite 24 | 22 | 1,904 | 177 | No |
| | Suite 22 | 22 | 1,915 | 178 | No |
| | Suite 21 | 10 | 911 | 85 | Yes |
| | Suite 18 | 15 | 1,329 | 123 | Yes |
| Second floor | Suite 15 | 27 | 2,386 | 222 | Yes |
| | Suite 12 | 11 | 995 | 92 | Yes |
| | Suite 9 | 9 | 809 | 75 | Yes |
| First floor | Suite 3 | 14 | 1,254 | 117 | Yes |
| | Suite 1 | 29 | 2,560 | 238 | Yes |
| TOTAL | | 159 | 14,063 | 1,307 | |

FIRST FLOOR

Suite 1

2,560 sq ft / 238 sq m
10 parking spaces
29 people

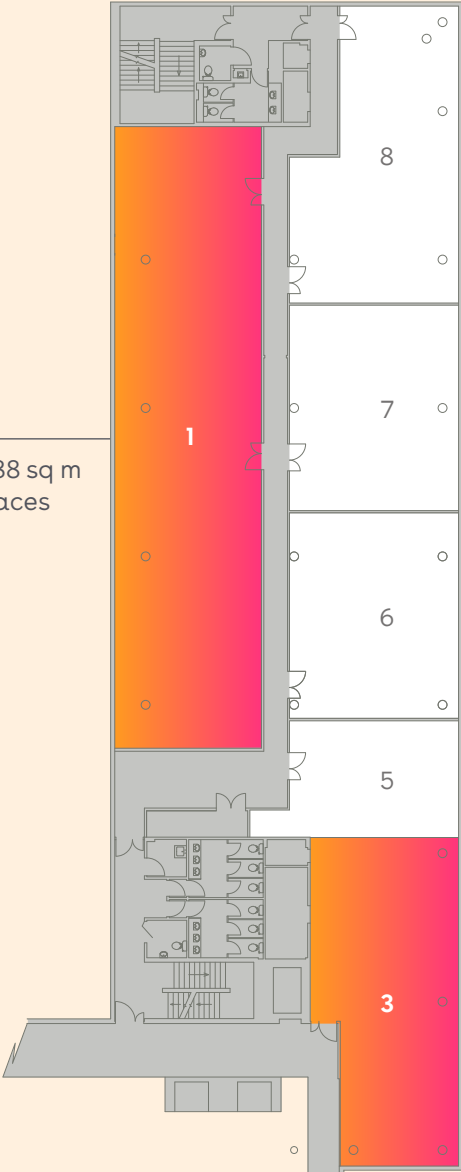

Suite 3

1,254 sq ft / 117 sq m
5 parking spaces
14 people

For indicative purposes only. Not to scale.

SECOND FLOOR

Suite 15

2,386 sq ft / 222 sq m
10 parking spaces
27 people

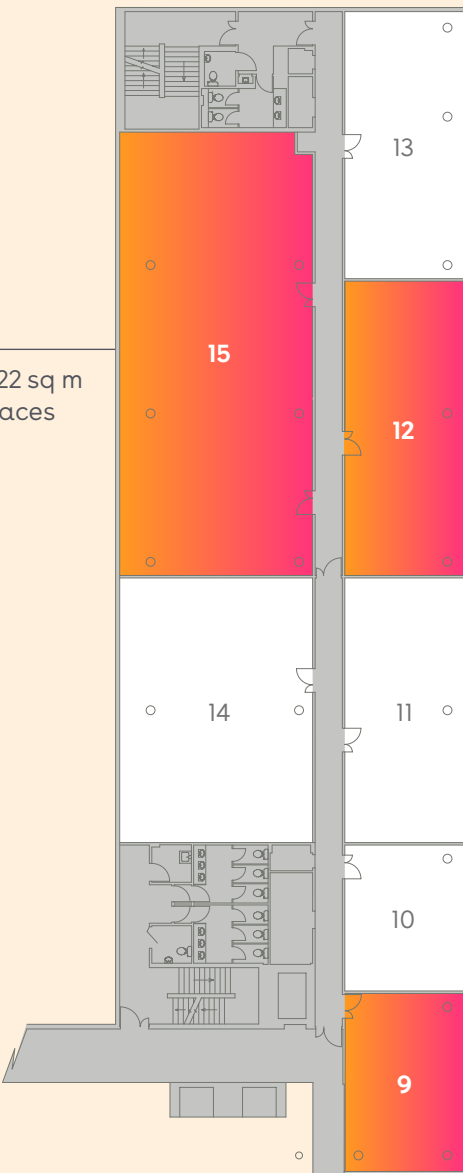

Suite 12

995 sq ft / 92 sq m
4 parking spaces
11 people

Suite 9

809 sq ft / 75 sq m
3 parking spaces
9 people

For indicative purposes only. Not to scale.

THIRD FLOOR

Suite 24

1,904 sq ft / 177 sq m
8 parking spaces
22 people

Suite 22

1,915 sq ft / 178 sq m
8 parking spaces
22 people

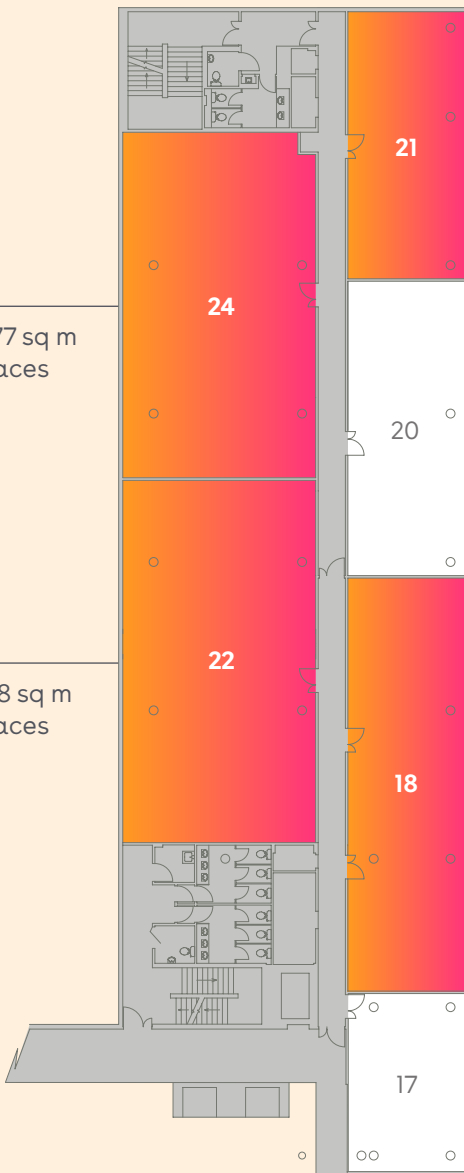

Suite 21

911 sq ft / 85 sq m
3 parking spaces
10 people

Suite 18

1,329 sq ft / 123 sq m
5 parking spaces
15 people

For indicative purposes only. Not to scale.

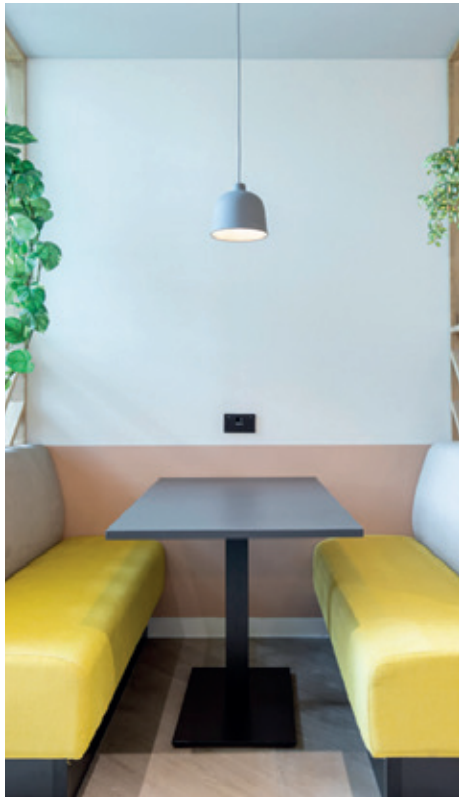



Find out more about bringing your business to Green Park. Contact our appointed leasing agents or visit greenpark.co.uk

**CAMPBELL
GORDON.**

ROB MARSON
+44 (0)118 959 7555
+44 (0)7778 467 781

FERGUS HAIG
+44 (0)118 959 7555
+44 (0)7553 141 137

GREENPARK.CO.UK



These particulars are not an offer or contract, nor part of one. Any information given is entirely without responsibility or warranty whatsoever. September 2023.

GreenPark 
a mapletree property